

2J470B 2J470BG

(Datasheet)

Type
Frequencies

Combined antenna
GSM (900 MHz)
DCS (1800 MHz)
3G (UMTS 2.1 GHz)

Mounting
Revision

GPS (1575.42 MHz)
GLONASS (1592 - 1610 MHz)
Body Mount
00



P. Tipul

D. Noble



1. SPECIFICATION

1.1. Electrical Specifications

Mobile (Cable 1)

Frequencies	GSM (900 MHz) DCS (1800 MHz) 3G (UMTS 2.1 GHz)
Impedance	50 Ohms
Polarization	VERTICAL
Gain	0dBi
VSWR	<2:1

Navigation (Cable 2)

Frequencies	GPS (1575.42 MHz) GLONASS (1592 - 1610 MHz)
Impedance	50 Ohms
Polarization	RHCP
LNA Gain	32 dB typ. (5V)
Voltage supply	1.8V to 5V
Current	5mA (1.8V), 13mA (3.3V), 25mA (5V)
Power (max.)	125mW Max.

General

IP rating	IP69K
Operating temperature	-40°C to +85°C

1.2. Connection Specifications

1.2.1. Default (recommended)

Cable 1 (Mobile):

Connector type: FME female
Cable: RG174U
Cable length: 250 cm

Cable 2 (Navigation):

Connector type: SMA male
Cable: RG174U
Cable length: 250 cm

1.3. Mechanical Specifications and Dimensions

1.3.1. Body mount

Material: ABS
 Max. dimensions: 52mm x 18.5mm
 Weight: 124 g 'counted with default connection'
 Colour: Black (for different colours please ask our sales team)

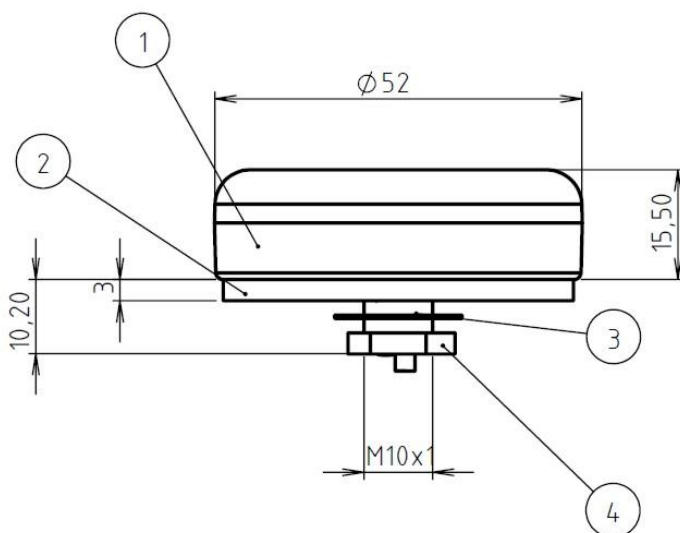

ITEM NO.	PART NO.	DESCRIPTION	QTY.
1	2J470 Housing	ABS Housing	1
2	Round Sticker	3mm Foam Sticker	1
3	washer	Washer with teeth DIN6798 I10,5 7n	1
4	nut	Nut nickel M10x1	1

2. MEASUREMENT

2.1. GSM:

VSWR (Quad Band)

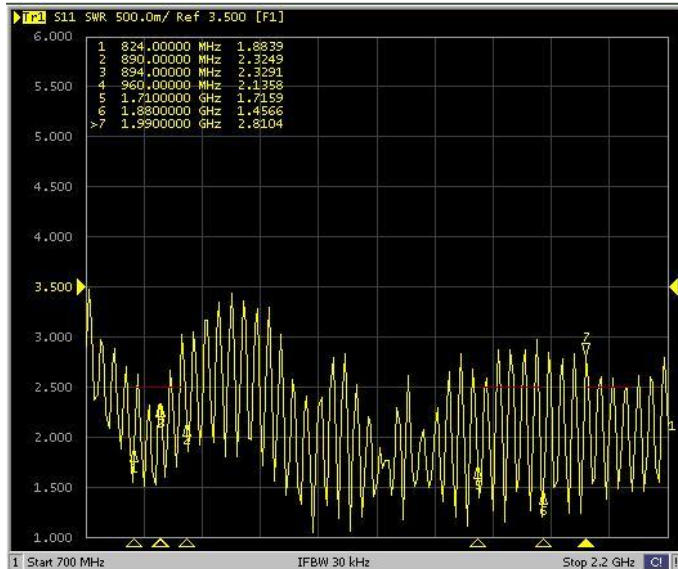

Tested with 3m cable length

Log Mag (Quad Band)

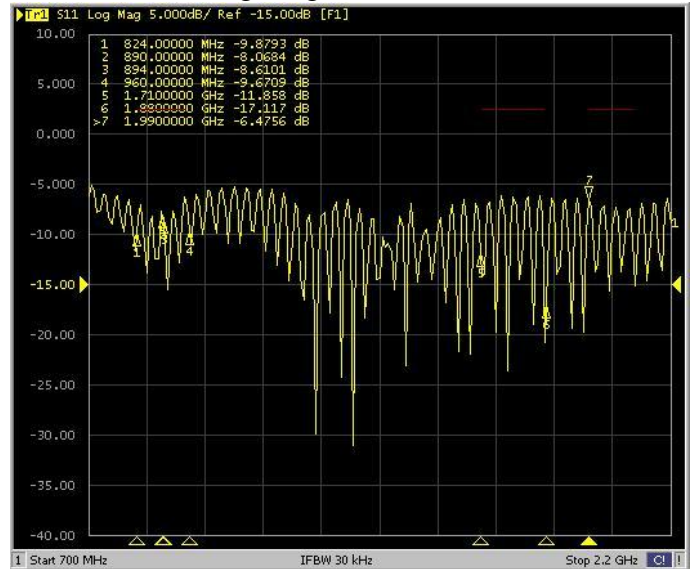

Tested with 3m cable length

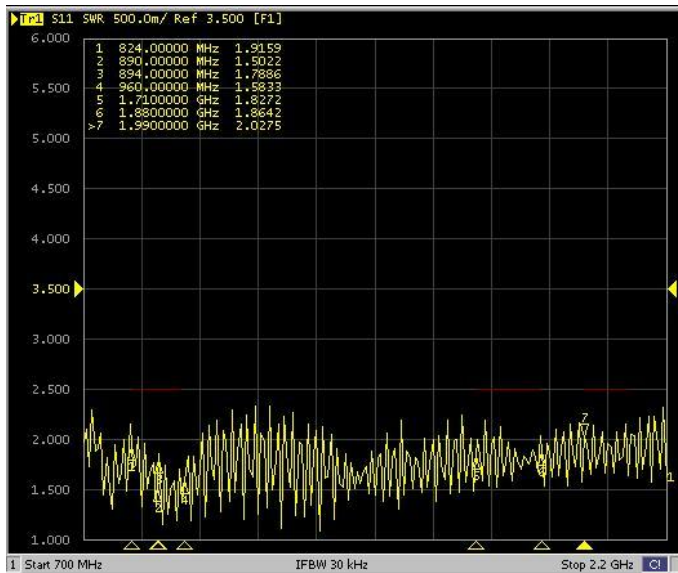

Tested with 5m cable length

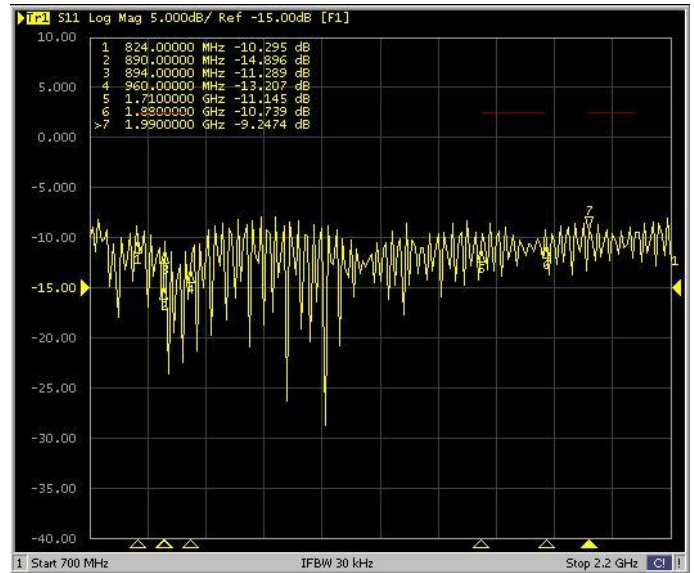

Tested with 5m cable length

2.2. GNSS

Log Mag at 3V

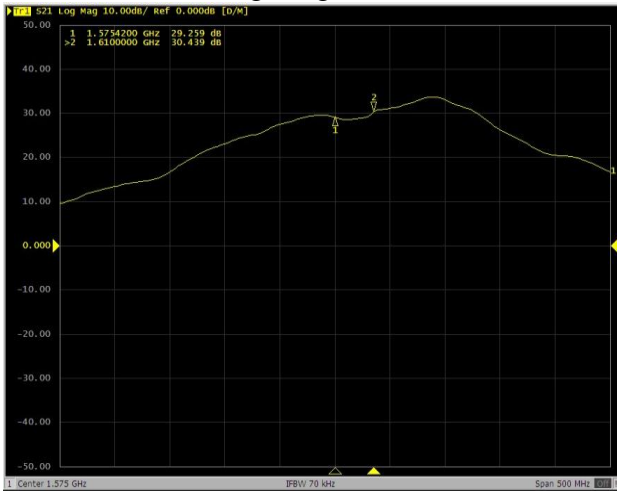

Tested with 1m cable length

Log Mag at 5V

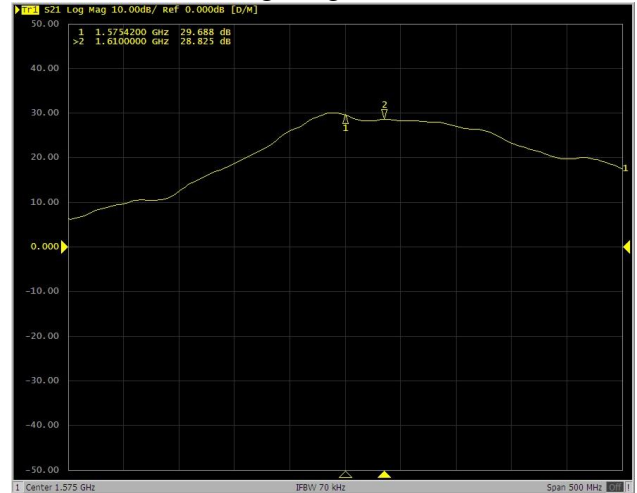

Tested with 1m cable length

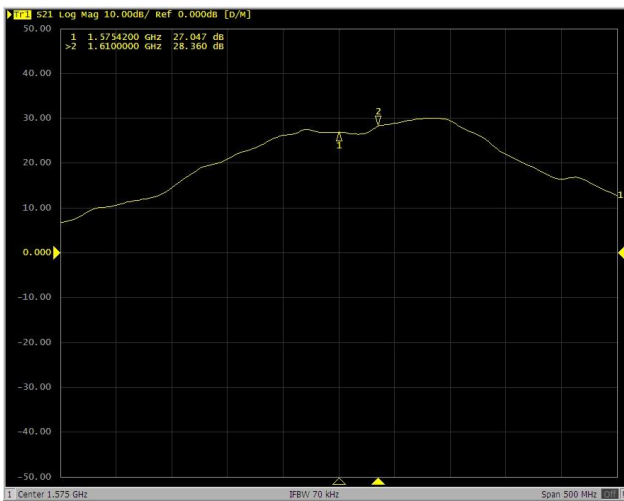

Tested with 3m cable length

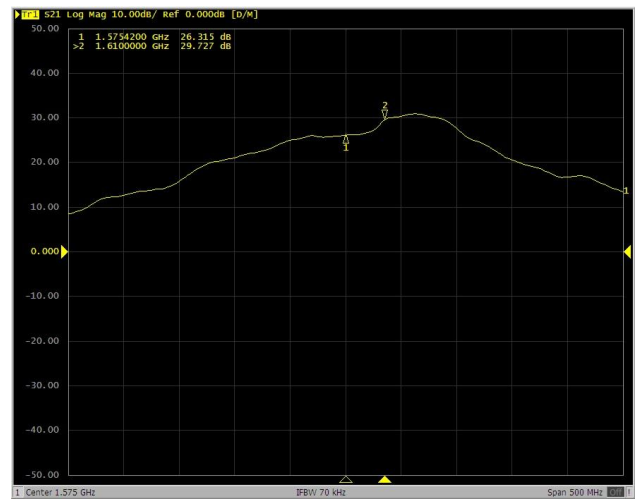

Tested with 3m cable length

3. IMAGES

